

MD386/MD386B Cut-Seal-Print Complexer

Brief Guidance to Operation Mode 1—Cut-Seal-Print

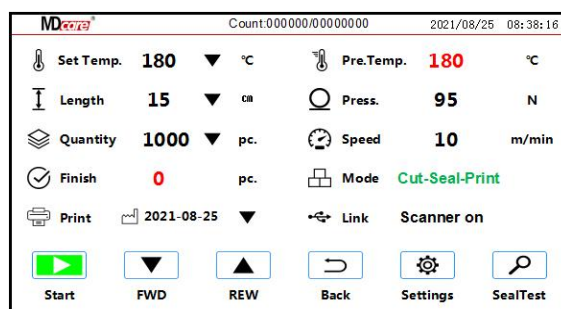

1 . Loading the reel

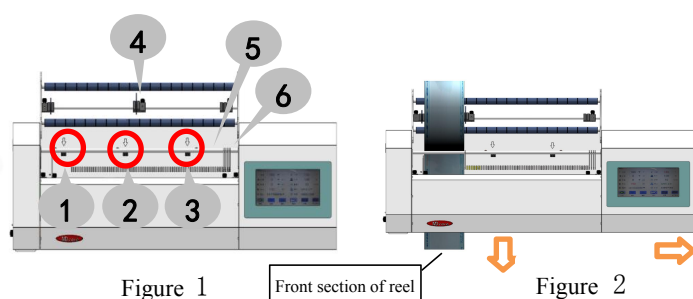

Figure 1

Front section of reel

Figure 2



Correct: The curve of the reel is down-warding.
Wrong: The curve of the reel is up-warding.

Figure 3

- ①/②/③ — sensors
- ④ — fixing plate (movable)
- ⑤ — lever
- ⑥ — separator (movable)

1. The reel/reels must be placed at a position corresponding to Sensor ① or ② or ③;
2. The reel/reels shall be inserted under the lever ⑤; Note the curve of the reel should be down-warding. Refer to Chapter 3 of User's Manual for details.
3. Move the fixing plate ④ and insert the reel separator ⑥ into an appropriate slot.

2 . Running operation

Start the machine

Select: **Cut-Seal-Print**

Loading the reel: as shown in Figure 1、2、3

Click the button "FWD", "REW"

For temperature、length、quantity setting

Click the corresponding ▼

For printing setting

Click ▼
Select the options

Wait for the heating system to heat up

※ Or printing all or not

Current temperature is in accord with the set temperature

※ For sealing test, Just click the button

Click the button "Start"

Feed Seal Test sample form the inlet on the left side of the machine

The machine is running

※ Turn off the power as appropriate

※ If it is required to pause running, press the "Stop" button

MD386/MD386B Cut-Seal-Print Complexer

Brief Guidance to Operation Mode 2—Seal or Seal and Print

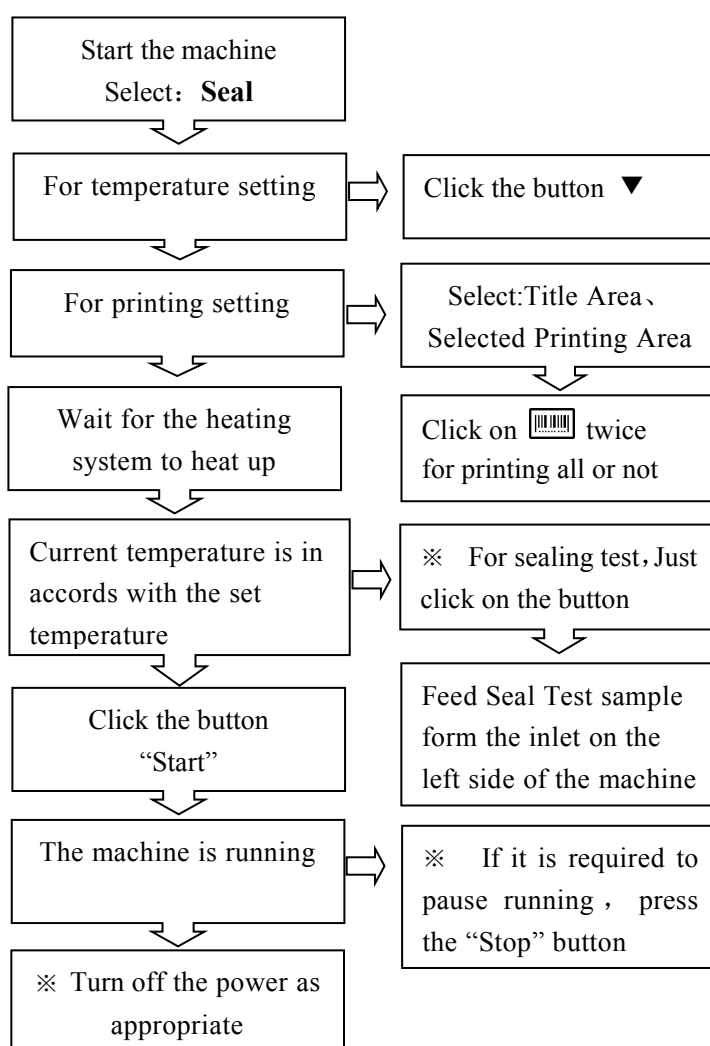
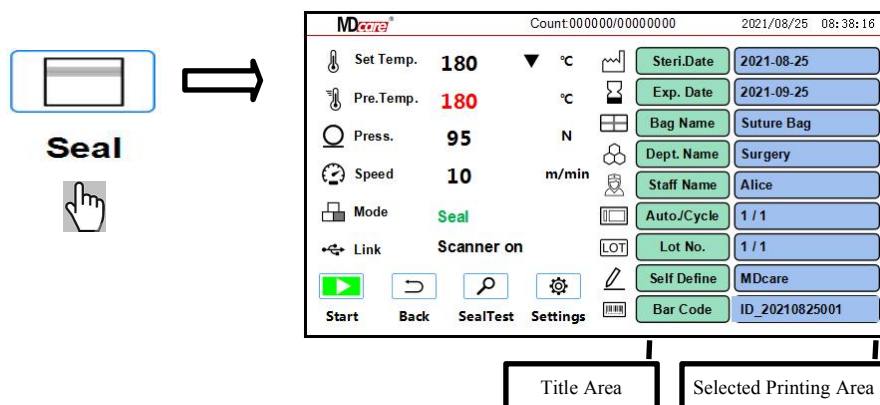

Warning: The equipment in the pouch may not overrun the arrow position. Otherwise, it may damage the machine

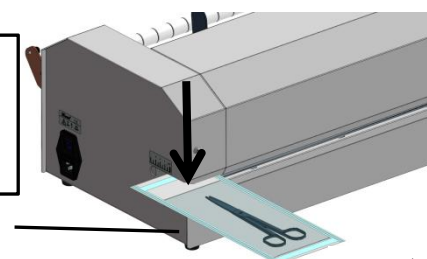
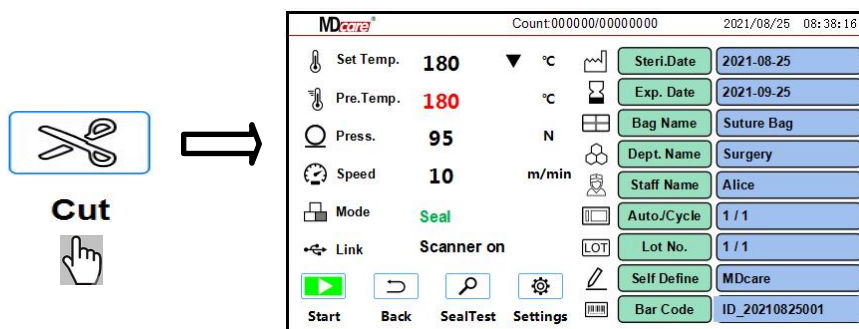

Figure 1

MD386/MD386B Cut-Seal-Print Complexer

Brief Guidance to Operation Mode 3—Cut



1 . Loading the reel

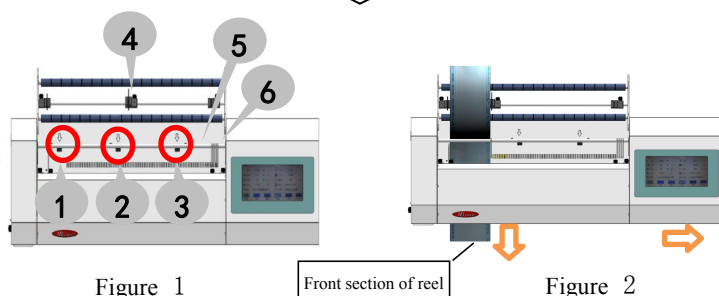

Figure 1

Front section of reel

Figure 2



Correct: The curve of the reel is down-warding.
Wrong: The curve of the reel is up-warding.

Figure 3

- ①/②/③ — sensors
- ④ — fixing plate (movable)
- ⑤ — lever
- ⑥ — separator (movable)

1. The reel/reels must be placed at a position corresponding to Sensor ① or ② or ③;
2. The reel/reels shall be inserted under the lever ⑤;
Note the curve of the reel should be down-warding.
Refer to Chapter 3 of User's Manual for details.
3. Move the fixing plate ④ and insert the reel separator ⑥ into an appropriate slot.

2 . Running operation

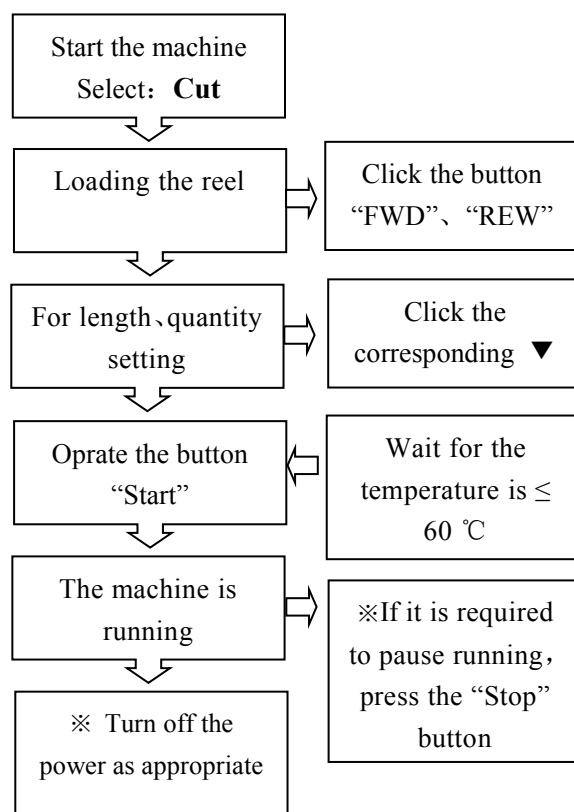

Warning when process Cutting:

When the processing reel(s) do not pass above it, or the device may mis-detect and display Jam error.
Only processing reel is allowed to pass above the sensor.